

UNIVERSAL SERIES™

Window Coupling Install Guide

CASCADIA
WINDOWS & DOORS

COUPLING GUIDE

1. SLIDE IN INSTALLATION ANCHORS

Slide in strap anchors into the top and sides of each frame—at least two anchors per side. Leave room for shims when sliding anchors into the bottoms of the frames.

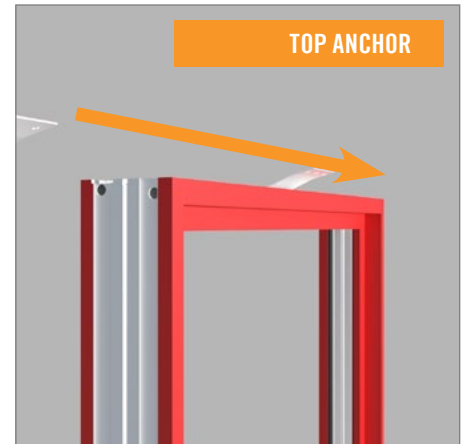
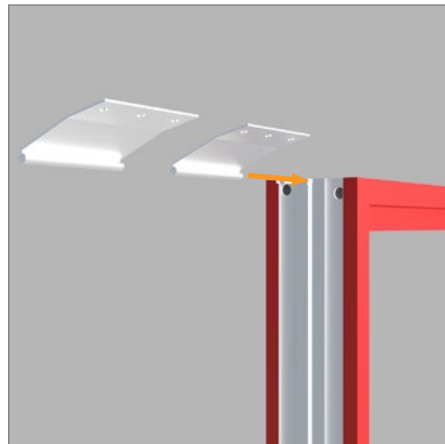
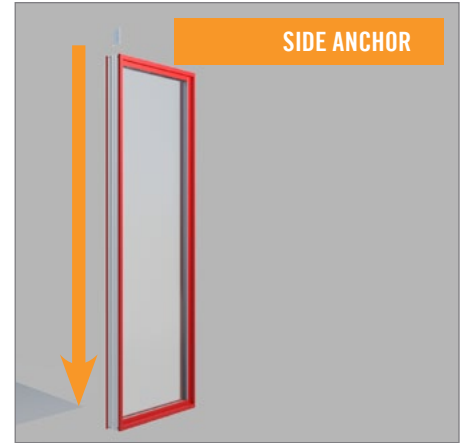
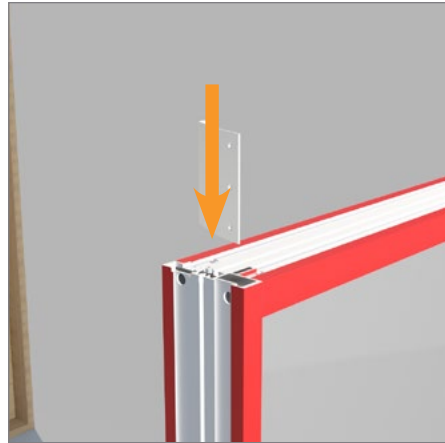

2. SLIDE IN FLASHING ATTACHMENT

Slide in flashing attachment into the bottom edge of the frame.

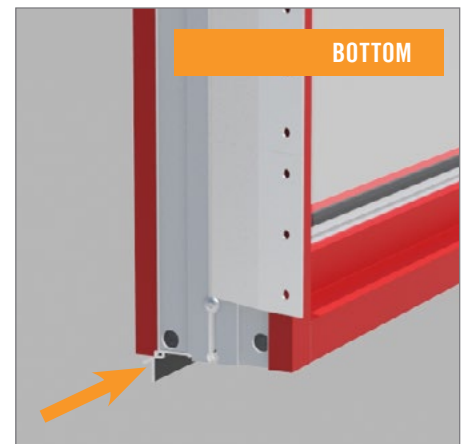
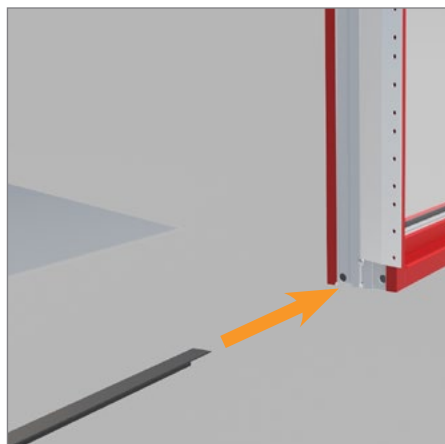

UNIVERSAL SERIES™

Window Coupling Install Guide

3. INSTALL EXTERIOR H-BAR

Once flashing is installed, place the frame in the opening and secure in place by sliding an anchor mount up to vertical centre and screwing in place.

Apply sealant to the full length of the exterior H-bar, then push into place along inner edge of exterior face of the frame.

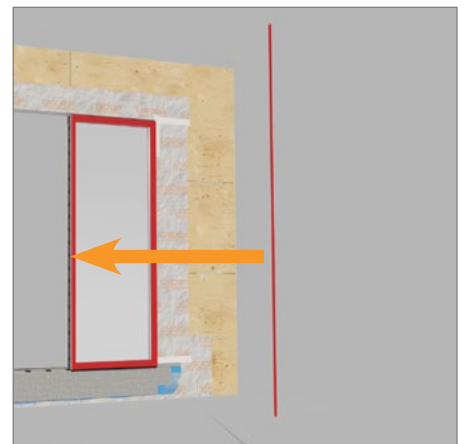
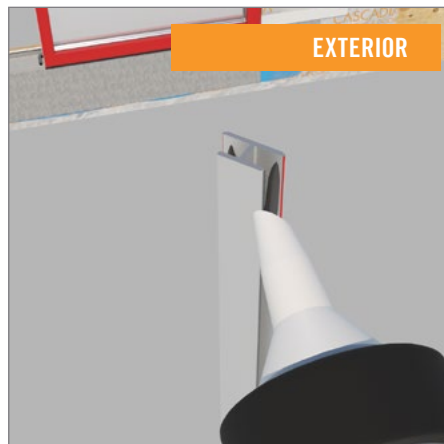
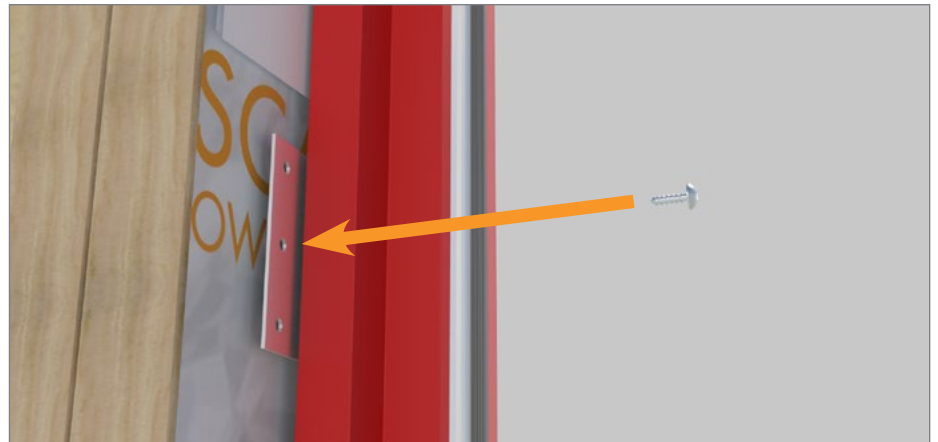

3. INSTALL INTERIOR H-BAR

Repeat steps 1 & 2 with second frame.

Apply sealant to the full length of the interior H-bar, then push into place along inner edge of the interior face of the frame.

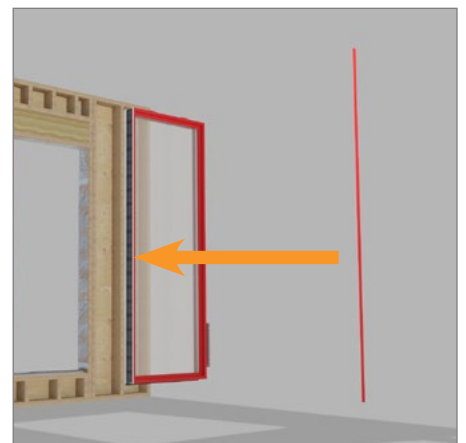
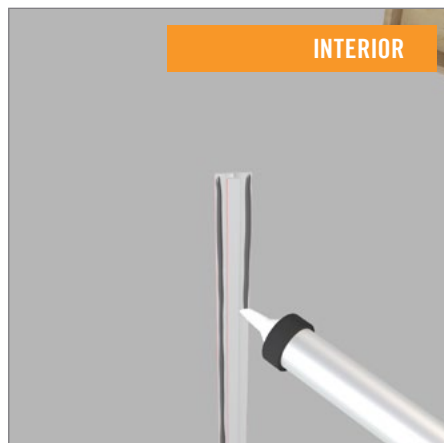

UNIVERSAL SERIES™

Window Coupling Install Guide

4. PUSH FRAMES TOGETHER

Slide second frame into place, bottom edge first. Interior H-bar should slightly overlap the edge of the interior of the first frame.

Once the second frame is in place, use a clamp on the interior face to push the two frames securely together.

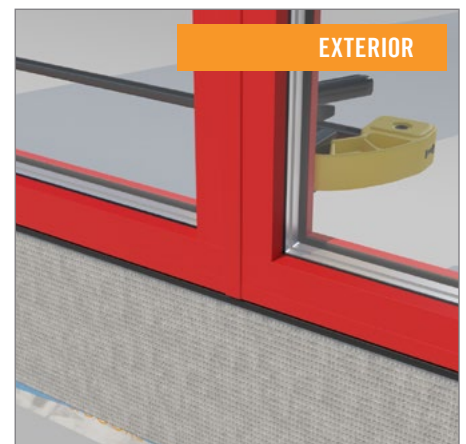
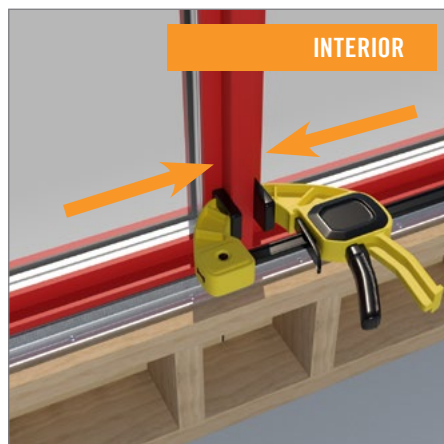
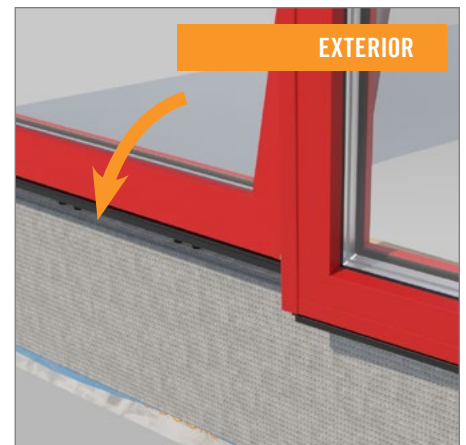
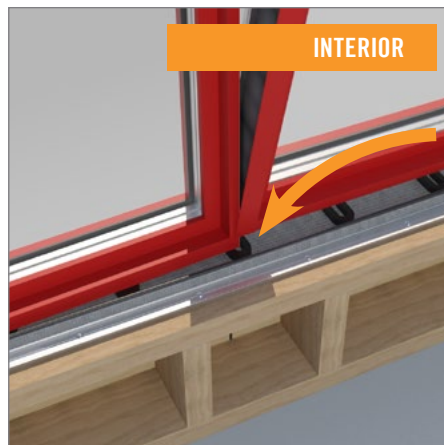

5. CENTRE WINDOW IN OPENING AND SCREW TO SILL ANGLE

Secure window for centring by sliding a second anchor mount up to vertical centre and screwing in place.

Ensure the window is centred in the opening, then screw into sill angle.

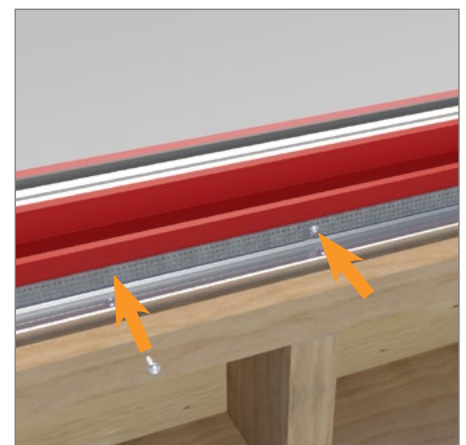

UNIVERSAL SERIES™

Window Coupling Install Guide

6. APPLY SEALANT BEHIND ALL ANCHORS

Remove temporary anchor screws and apply sealant behind all anchors. Ensure window is plum, level and square before installing remaining screws.

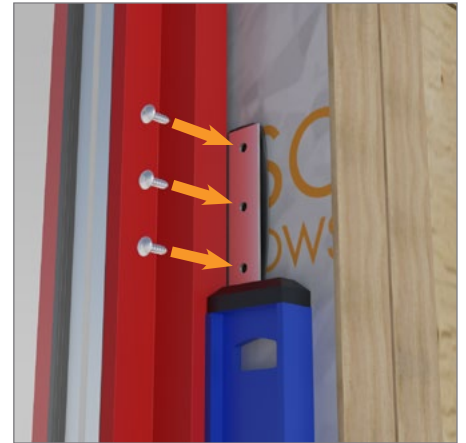
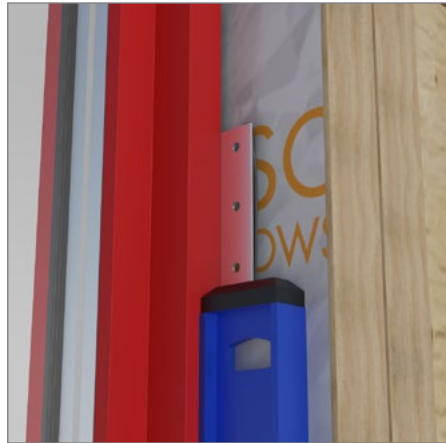
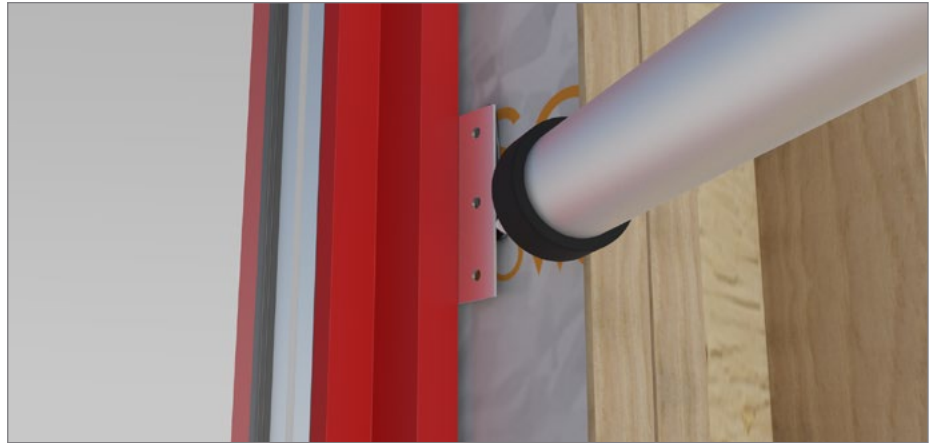

7. INSERT BACKER ROD AROUND WINDOW

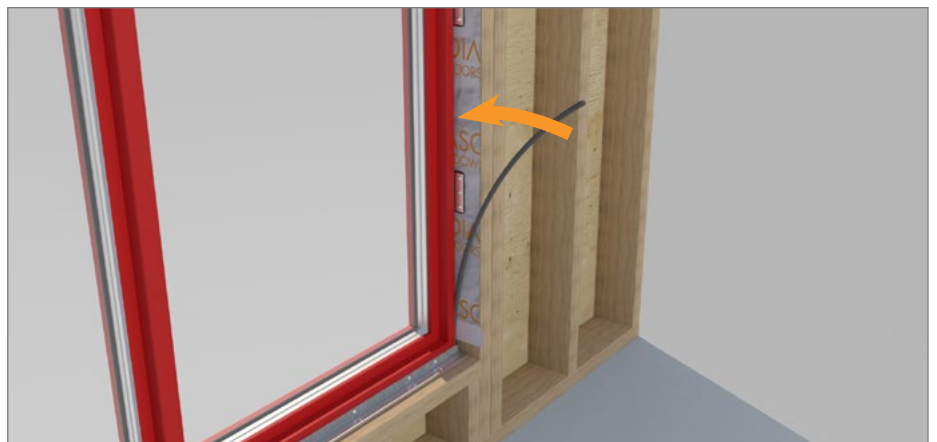

UNIVERSAL SERIES™

Window Coupling Install Guide

CASCADIA
WINDOWS & DOORS

8. APPLY SEALANT TO BACKER ROD

Apply sealant to the backer rod all the way around. Tool the sealant.

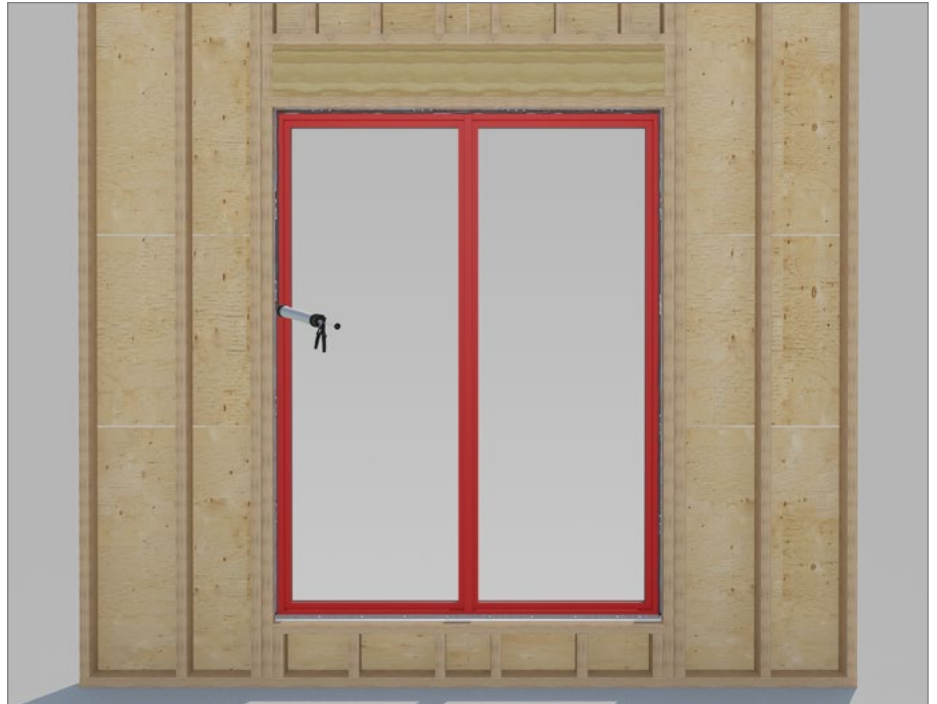

9. APPLY SILL COVER CAP (OPTIONAL)

Ensure a tight fit by hammering in place with a soft mallet.

