

ALUMINUM GRID

ADHESIVE TAPE

SDL BAR - 1" x 3/16"  
INSTALLED BY CASCADIA

EXTERIOR

INTERIOR

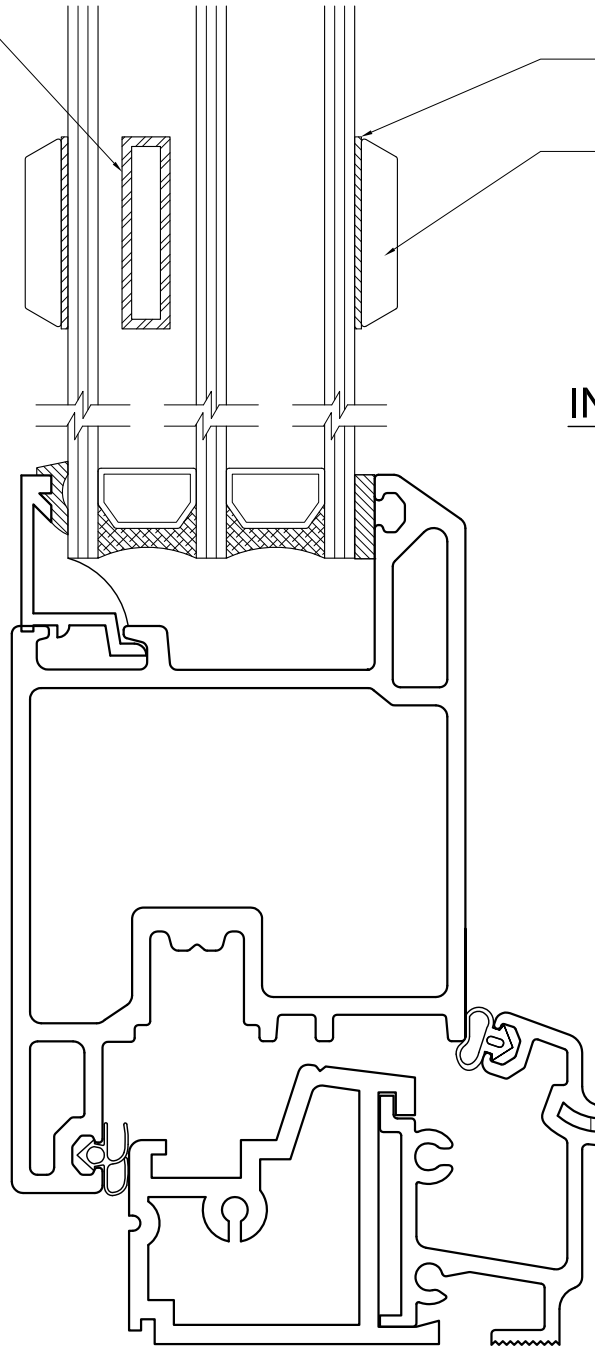

**SECTION DETAIL**

**NOTE:** THIS DETAIL IS FOR GENERAL ARRANGEMENT PURPOSES ONLY, AND DOES NOT NECESSARILY REPRESENT A DETAIL THAT IS APPROPRIATE FOR A SPECIFIC PROJECT. PRODUCTS AND ACCESSORIES PROVIDED BY CASCADIA MUST BE CONFIRMED FOR SPECIFIC PROJECTS.



**CASCADIA WINDOWS LTD.**  
27050 GLOUCESTER WAY  
LANGLEY, BC CANADA, V4W 3Y5

SERIES:		<b>SIMULATED DIVIDED LIGHT (SDL)</b> TYPICAL SDL BAR - 302 SERIES		DRAWING NO.:	1.09
DRAWING TITLE:		DOUBLE GLAZED - 1" x $\frac{3}{16}$ " SDL BAR		PROJECT NO.:	0-01
ISSUE	DESCRIPTION	DATE	SCALE:	1'-0" = 1'-0"	
			DATE:	18 JAN / 2011	
			DRAWN BY:	AN	
			CHECKED BY:	-	